

NOTE :

- The front guard has its mounting holes in different positions between CAB models and ROPS models. Referring to the figure below, select their respective proper mounting holes.

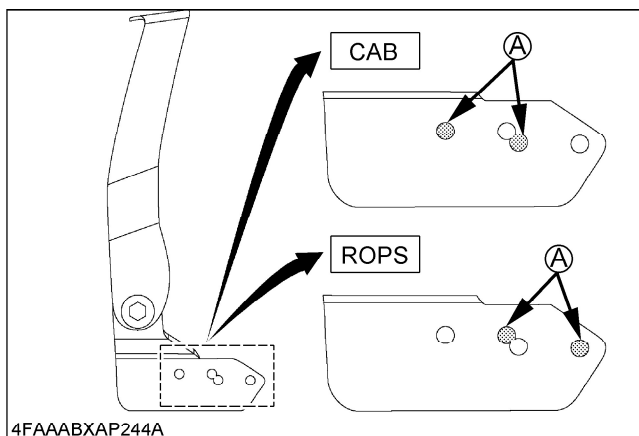

(A) Proper mounting hole

IMPORTANT:

[When installing the old type mower]

- When the nuts, which is fixing the bolt of the front guard, contact the front hanger bracket of the mower, cut the front hanger bracket as shown in the illustration below.

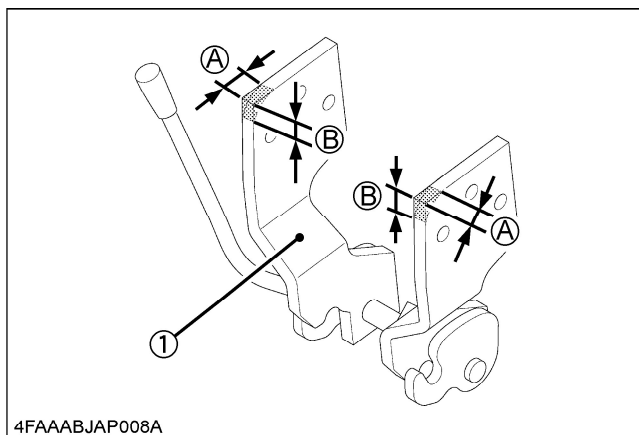

(1) Front hanger bracket

[RCK60-30B]

(A) 30 mm (1.18 in.)

(B) 20 mm (0.78 in.)

[RC72-27B]

(A) 40.5 mm (1.59 in.)

(B) 16.5 mm (0.64 in.)

NOTE :

- Before finally tightening all mounting hardware, start the engine and apply down pressure to the bucket until the loader raises the front wheels slightly, and make sure that the mounting pins can be rotated easily. Tighten all bolts and nuts in this position.

3RD FUNCTION (IF EQUIPPED)

■ Loader Side Section

1. Attach the coupler stay to the boom.

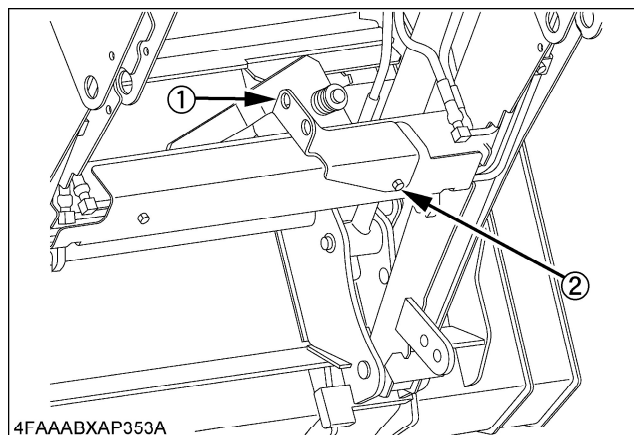

(1) Coupler stay

(2) M8 x 30 bolt with washers

2. Removing right boom cylinder and install 3rd function hydraulic tubes as shown below.

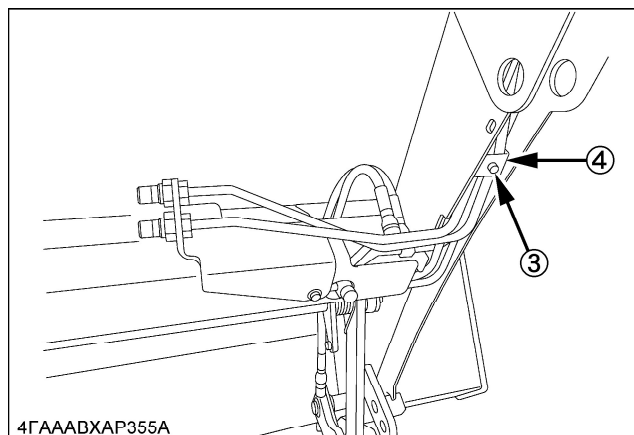
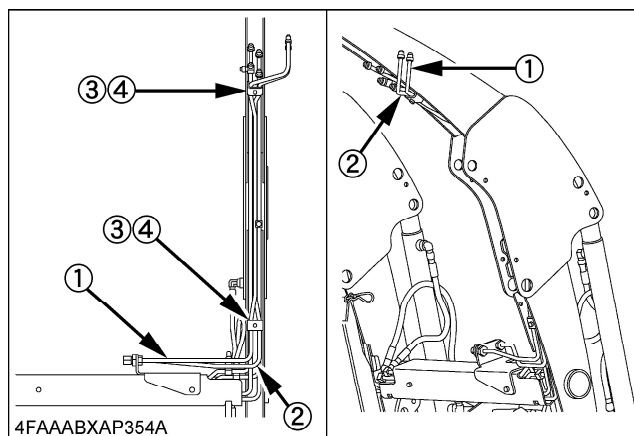

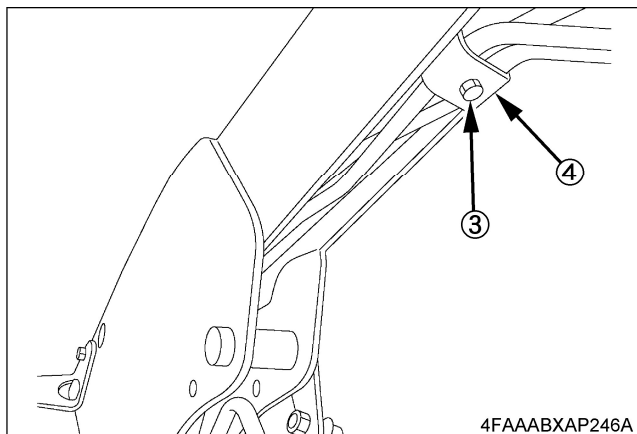

- (1) Hydraulic tube 1 (Black)
 (2) Hydraulic tube 2 (Green)
 (3) 2-M6 x 25 bolts with washers
 (4) 2-Tube stays

IMPORTANT :

- Remove the original tube stays fixing the four loader tubes, and fix the six tubes together using the tube stays in the kit.

3. Fix the tubes with nuts and cover the end with metal caps.

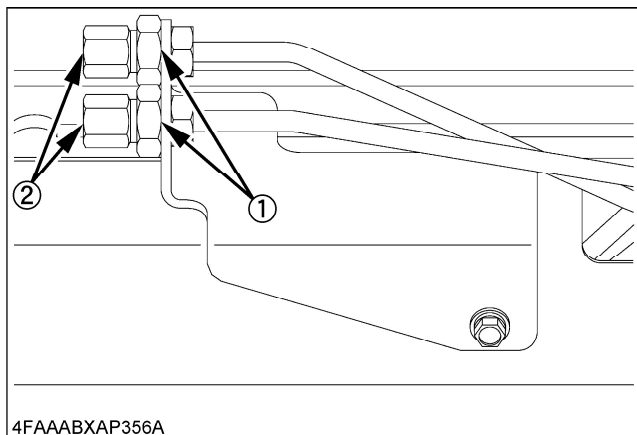

- (1) 2-Nuts (3/4 UNF)
 (2) 2-Caps (3/8 NPTF)

IMPORTANT :

- Wrap seal tape around male thread before installing the caps.

4. Install the right boom cylinder.

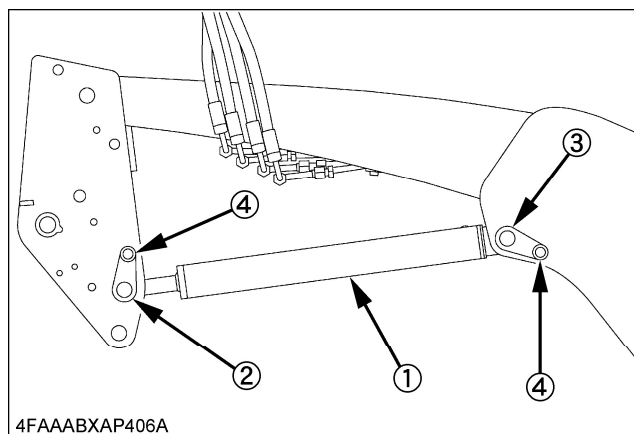

- (1) Right boom cylinder (original)
 (2) Pin(5) (101.5 mm, original)
 (3) Pin(1) (80.5 mm, original)
 (4) 2-M10 x 30 bolts with washers (original)
 2-M10 nylon nuts (original)

IMPORTANT :

- Pay attention to the length of the pins so as not to install them in the wrong positions.

5. Connect the boom hose to the right boom cylinder again.

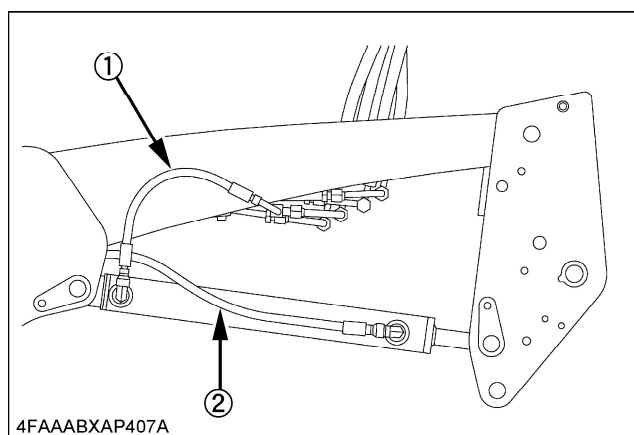

- (1) Boom cylinder bottom hose (320 mm, 9/16 UNF, Yellow) (original)
 (2) Boom cylinder rod hose (667 mm, 9/16 UNF, White) (original)

6. Connect the 3rd function hose to the 3rd function tube.
[Without Swift-tach and MSL]

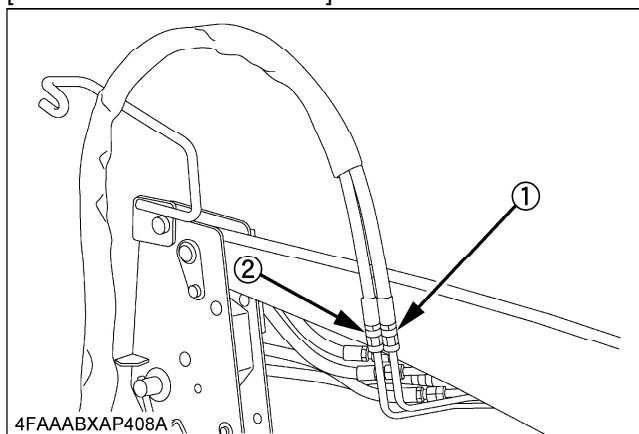

[With Swift-tach or MSL]

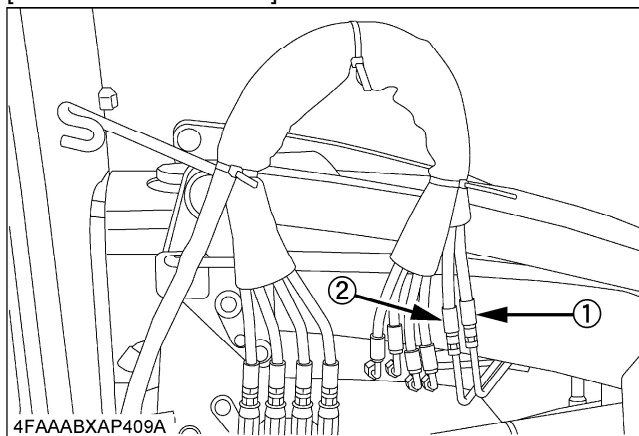

- (1) 3rd function A hose (1422 mm, 9/16 UNF, Gray)
(2) 3rd function B hose (1422 mm, 9/16 UNF, Green)

7. [If Swift-tach or MSL equipped] Secure the 3rd function hose to the back hose with the cord band at the position as shown in the following figure.

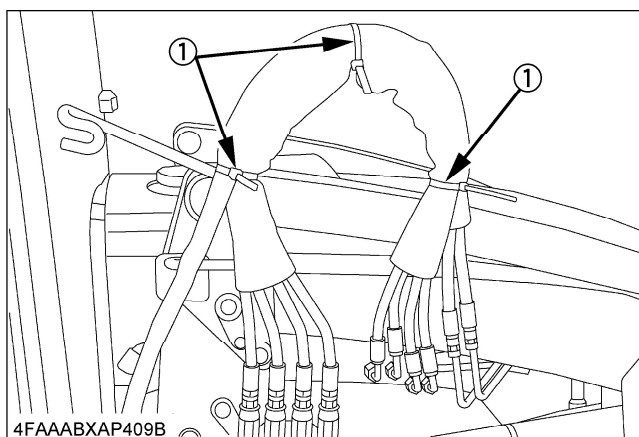

- (1) 3-cord band

◆ Hose guide

1. Install the hose guide on side frame RH as shown.

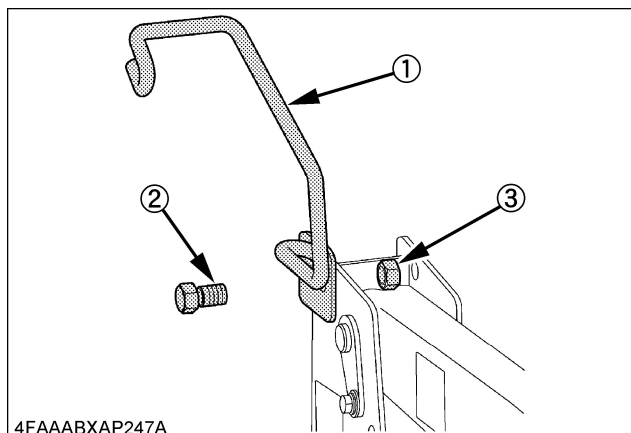

- (1) Hose guide
(2) M16 x 30 bolt
(3) M16 nut

◆ 3rd Function Valve section

1. Install 3rd function coupler stay to Main Frame (RH) as shown the chart below.

Combination (Figure)		A	B	C	D
Kit	3rd function	ON	ON	ON	ON
	MSL		ON		ON
	Swift-tach			ON	ON
Bolt length for 3rd Valve stay		40 mm	45 mm	45 mm	45 mm
Direction of bolt		In to Out	Out to In	Out to In	Out to In

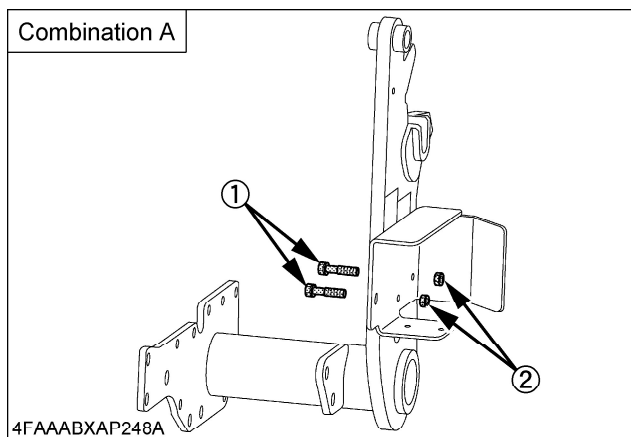

- (1) 2-M10 x 40 bolts
(2) 2-M10 nylon lock nuts

Combination B

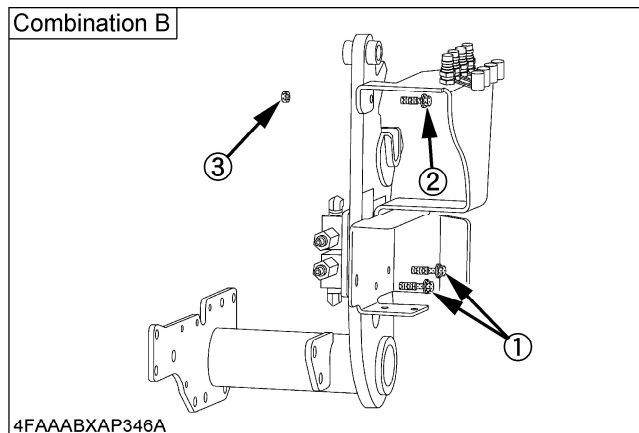

4FAAABXAP346A

- (1) 2-M10 x 45 bolts
- (2) M10 x 40 bolt with washers
- (3) M10 nut

Combination C

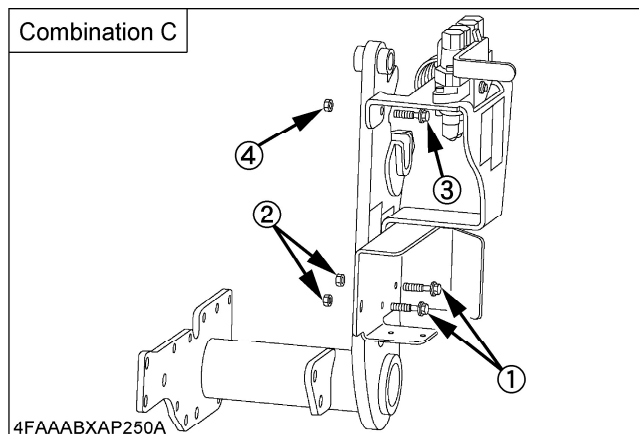

4FAAABXAP250A

- (1) 2-M10 x 45 bolts
- (2) 2-M10 nylon lock nuts
- (3) M10 bolt with washers
- (4) M10 nut

Combination D

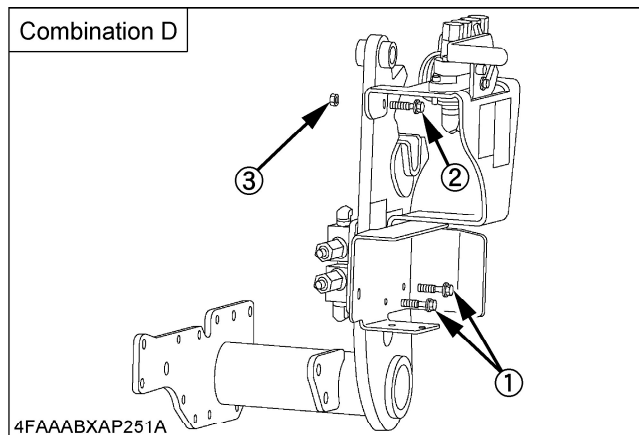

4FAAABXAP251A

- (1) 2-M10 x 45 bolts
- (2) M10 x 40 bolt with washers
- (3) M10 nut

2. Install the 3rd function vale to valve stay as shown in the figure.

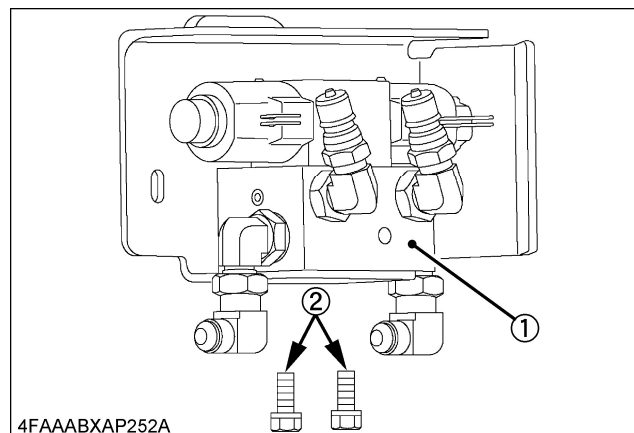

4FAAABXAP252A

- (1) 3rd function valve assy
- (2) 2-M10 x 25 bolts

◆ 3rd Function Hydraulic Line

[Not equipped with backhoe]

Use the following kit parts as shown below.

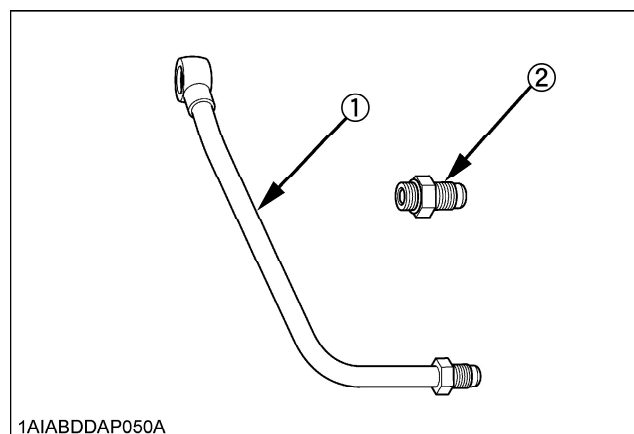

1A1ABDDAP050A

- (1) Power beyond pipe
- (2) Adapter

1. Disconnect the front loader power beyond pipe.

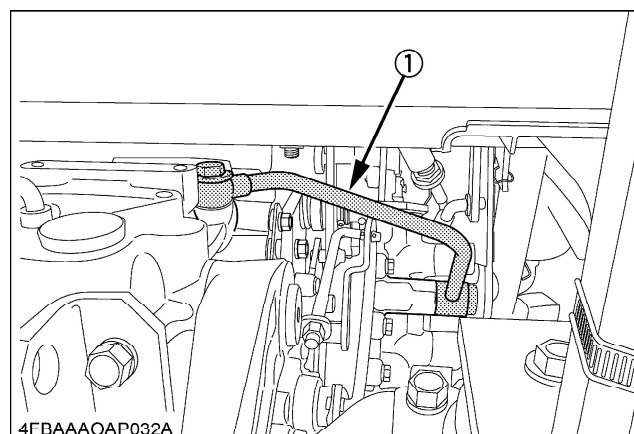

4FBAAOAP032A

- (1) Front loader power beyond pipe

2. Connect the power beyond pipe and adapter as shown below.

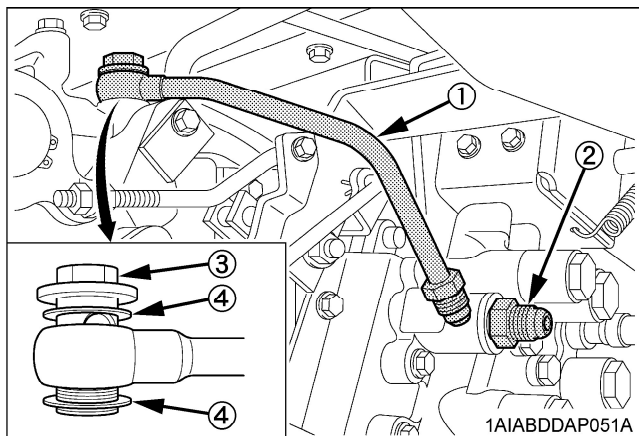

- (1) Power beyond pipe
(2) Adapter (3/4 UNF)
(3) Plug (Original)
(4) 2-Packing

(3)	Tightening torque	50 to 60 N•m (5.1 to 6.1 kgf•m) (37 to 44 lbf•ft)
-----	-------------------	---

NOTE :

- Tighten the plug (original) after all hoses are connected.

3. Connect the inlet hose to the adapter and connect the outlet hose to the power beyond pipe respectively.

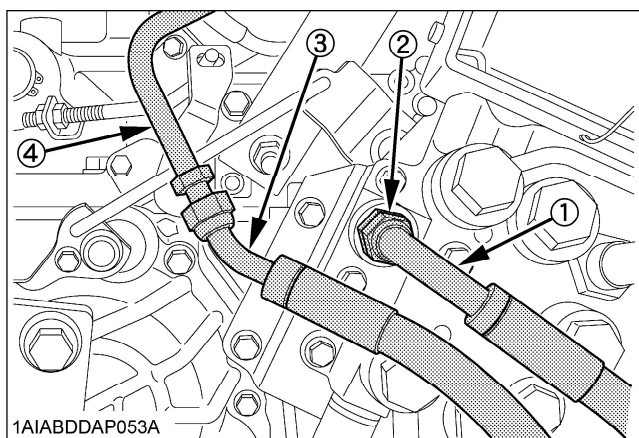

- (1) Inlet hose
(2) Adapter
(3) Outlet hose
(4) Power beyond pipe

4. Connect the hoses to the 3rd function assembly.

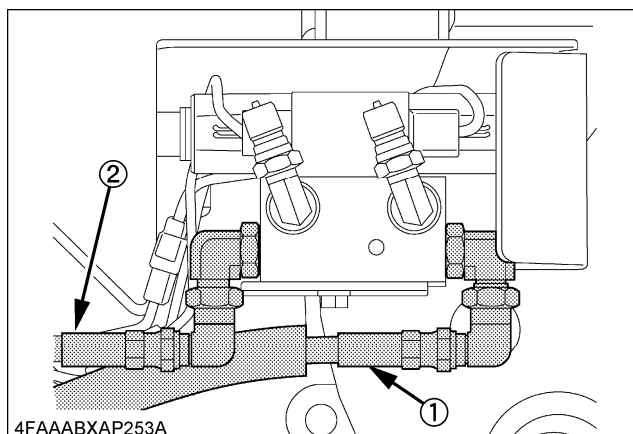

- (1) Inlet hose
(2) Outlet hose

5. Secure the inlet hose and outlet hose with the band as shown below.

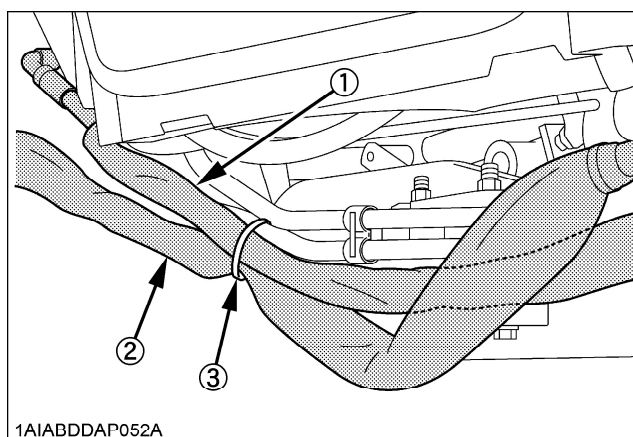

- (1) Inlet hose
(2) Outlet hose
(3) Band

[Equipped with backhoe]

If the backhoe kit has been equipped, disconnect the backhoe inlet pipe first and then remove the female coupler and dust plug.

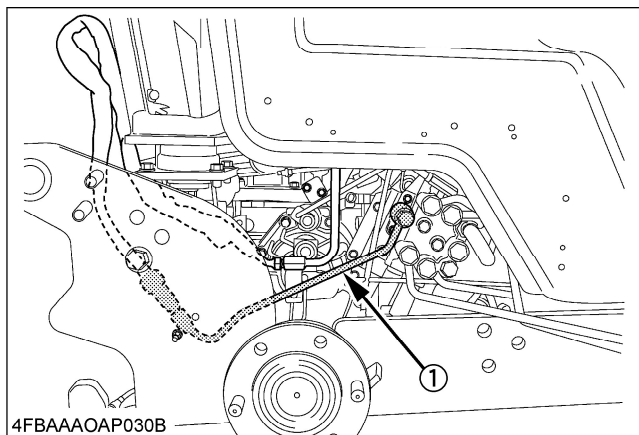

(1) Backhoe inlet pipe (Disconnect)

NOTE :

- The removed female coupler and dust plug will be used again for the power beyond pipe.

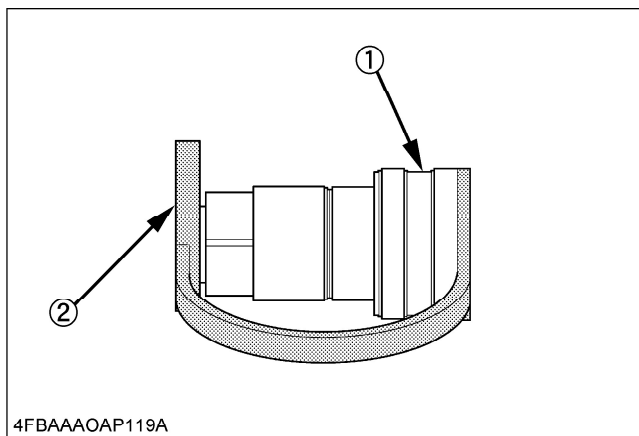

(1) Female coupler
(2) Dust plug

Use the following kit parts as shown below.

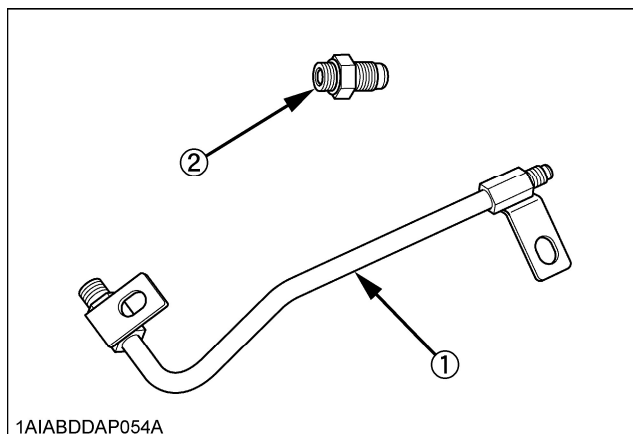

(1) Power beyond pipe
(2) Adapter

1. Disconnect the front loader power beyond pipe if equipped.

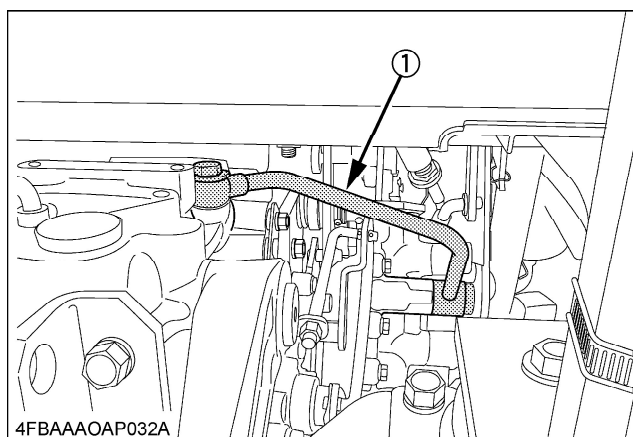

(1) Front loader power beyond pipe

2. Connect the adapter.

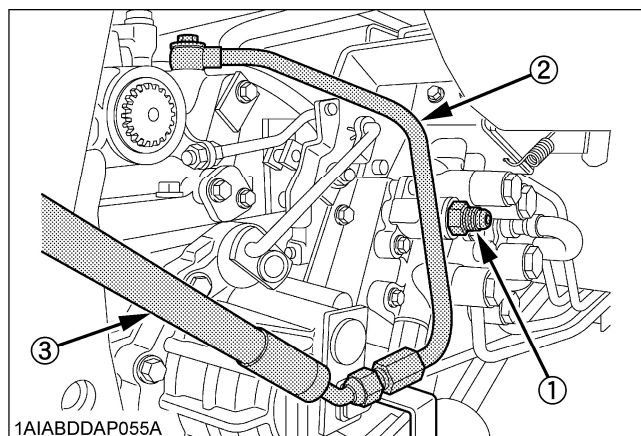

- (1) Adapter
(2) Backhoe outlet pipe (in the backhoe kit)
(3) Backhoe outlet hose (in the backhoe kit)

No.	Size	Tightening torque
(1)	3/4	48 to 54 N·m (4.9 to 5.5 kgf·m) (35 to 40 lbf·ft)

NOTE :

- Refer to the backhoe assembly instructions for the backhoe outlet pipe and backhoe outlet hose.

3. Attach the female coupler and dust plug to the power beyond pipe. At this time, use the removed female coupler and dust plug.

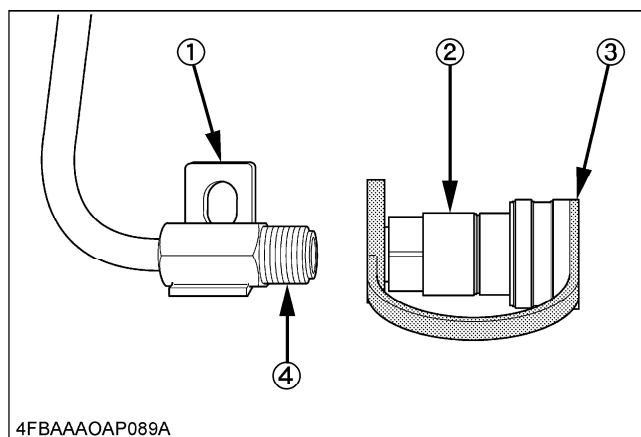

- (1) Power beyond pipe
(2) Female coupler (in the backhoe kit)
(3) Dust plug (in the backhoe kit)
(4) Sealing tape

Tightening torque	39 to 60 N·m (3.9 to 6.1 kgf·m) (29 to 44 lbf·ft)
-------------------	---

4. Connect the inlet hose to the adapter and connect the outlet hose to the power beyond pipe respectively.

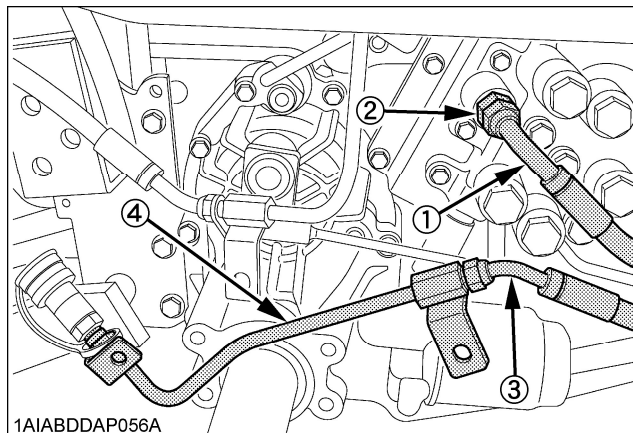

- (1) Inlet hose
(2) Adapter
(3) Outlet hose
(4) Power beyond pipe

No.	Size	Tightening torque
(1)	3/4	49 to 53 N·m (5.00 to 5.40 kgf·m) (36.2 to 39.0 lbf·ft)
(3)	9/16	25 to 28 N·m (2.55 to 2.85 kgf·m) (18.5 to 20.6 lbf·ft)

5. Secure the power beyond pipe with the backhoe sub frame and connecting plate.

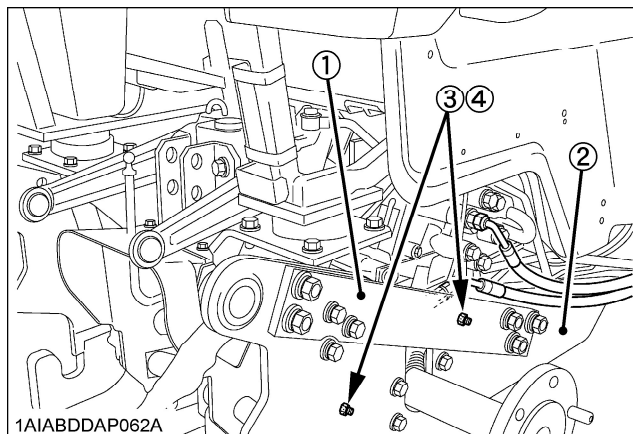

- (1) Connecting plate
(2) Sub frame
(3) 2-M8 x 30 bolts
(4) 2-M8 nuts

No.	Size	Tightening torque
(4)	M8	23.6 to 27.4 N·m (2.4 to 2.8 kgf·m) (17.4 to 20.2 lbf·ft)

6. Connect the hoses to the adapters of 3rd function assembly.

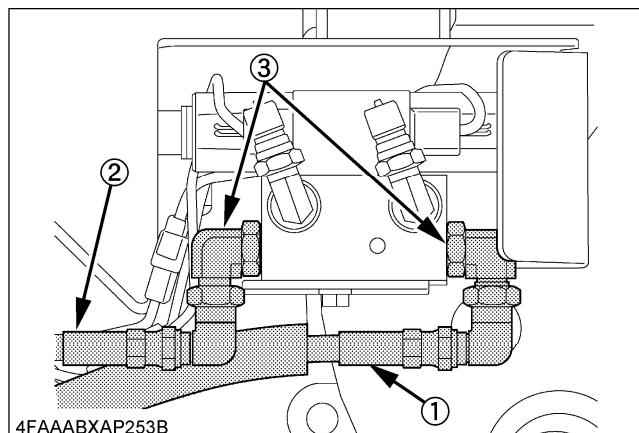

- (1) Inlet hose
(2) Outlet hose
(3) 2-Adapters

No.	Size	Tightening torque
(1) (2)	3/4	49 to 53 N·m (5.00 to 5.40 kgf·m) (36.2 to 39.0 lbf·ft)

7. Secure the inlet hose and outlet hose with the band as shown below.

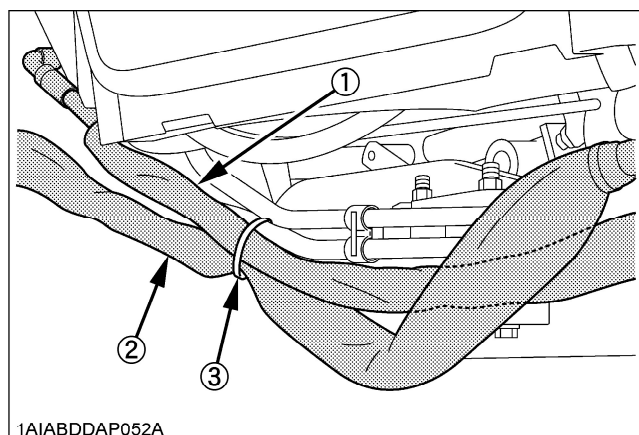

- (1) Inlet hose
(2) Outlet hose
(3) Band

■ Tractor Side/CAB Section

◆ Control Lever for CAB

1. Cut lever boot as shown below.

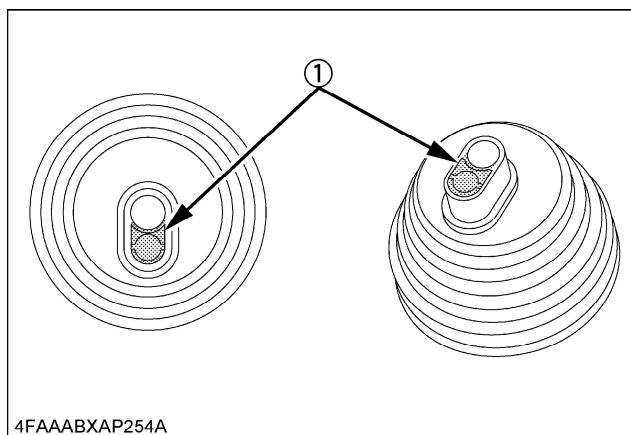

- (1) Cutting area

- Loosen the bolt on the lever and remove top half of lever and boot.
- Remove the lever console.
- Fit the 3rd function control lever wire harness and its stay into the lever.

◆ With Swift-tach (Foldable lever) (If necessary)

- Remove the lever assembly from its base.
- Draw out the pin. Separate the lever assembly from its base. Then remove the lever lock assembly.

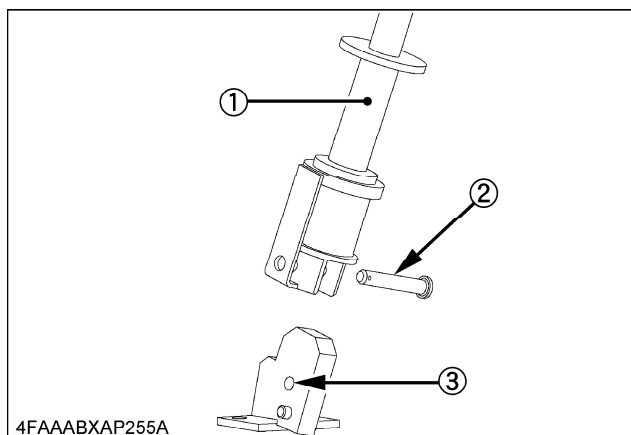

- (1) Lever assy
(2) Pin
(3) Lever base

3. Set the 3rd function control lever boot onto the lever lock assembly. Insert the cir-clip to fix them.

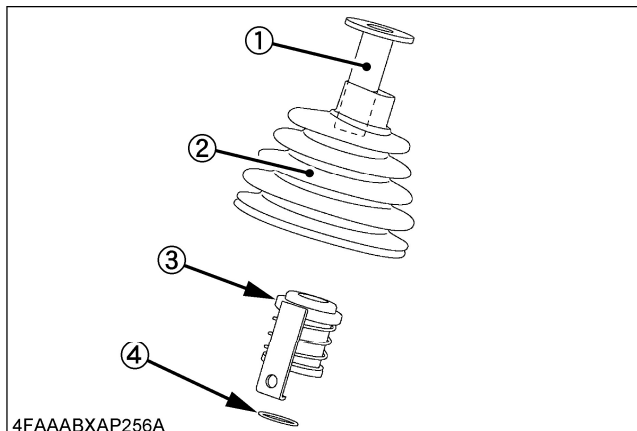

- (1) Lever lock (Upper)
(2) Lever boot (for 3rd function)
(3) Lever lock assy (Lower)
(4) Cir-clip

4. Put the 3rd function control lever through its lock assembly. Fit the wire harness guide into the boot as shown below. Then install the lever onto its base.

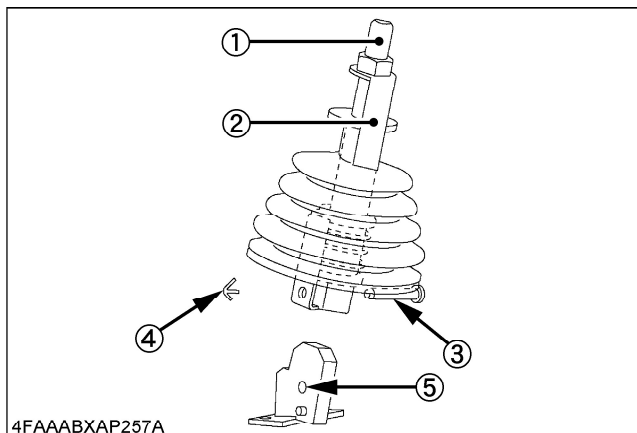

- (1) Control lever (3rd function, Lower)
(2) Harness guide
(3) Crevis pin
(4) Split pin
(5) Lever base

5. Place the control lever (upper) in position. Adjust the grip angle and tighten up the lock nut. Then route the wire harness along the boot.

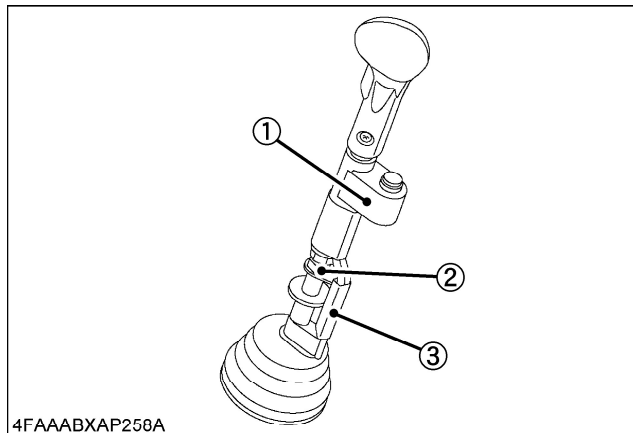

- (1) Control lever (3rd function, Upper)
(2) M12 nut
(3) 3rd function harness

6. Fit the lever to the tractor. Route the wire harness and clamp it with the cord bands as shown below.

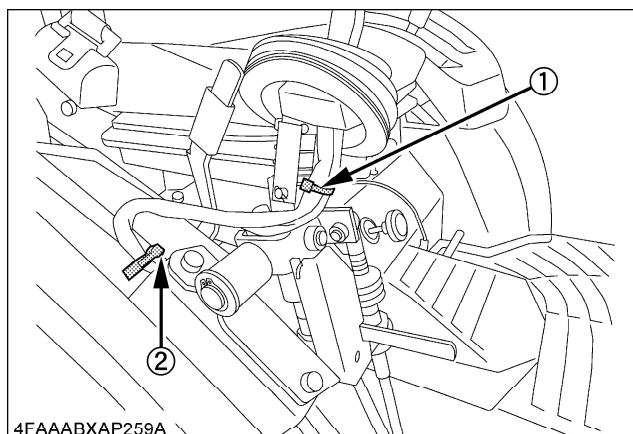
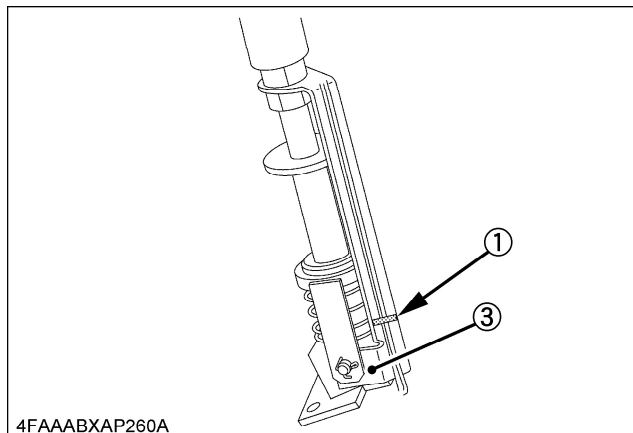

- (1) Band code (White)
(2) Band code (Black)
(3) Harness clamp stay

◆ Without Swift-tach

1. Remove the lever from its base.
2. Assemble the 3rd function control lever as shown below. Adjust the grip angle and tighten up the nut.

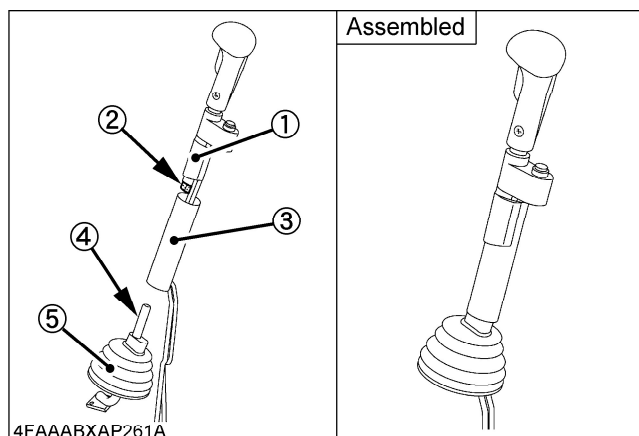

- (1) Control lever (3rd function, Upper)
- (2) M12 nut
- (3) Cover
- (4) Control lever (3rd function, Lower)
- (5) Boot

3. Fit the lever to the tractor. Clamp the wire harness in place.

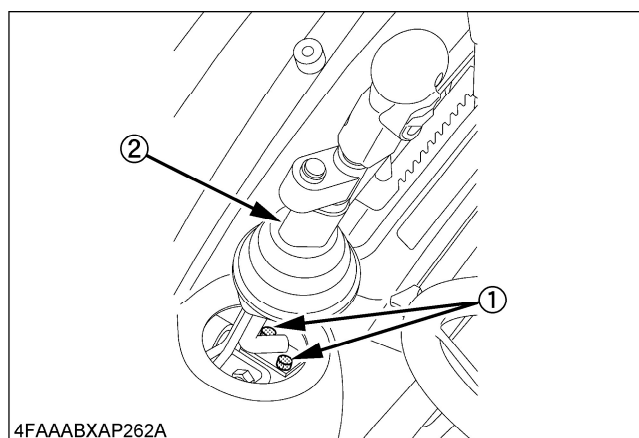

- (1) 2-M6 x 12 bolts (Original)
- (2) 3rd function lever assy

4. Lay the wire harness as shown below. Clamp it in place.

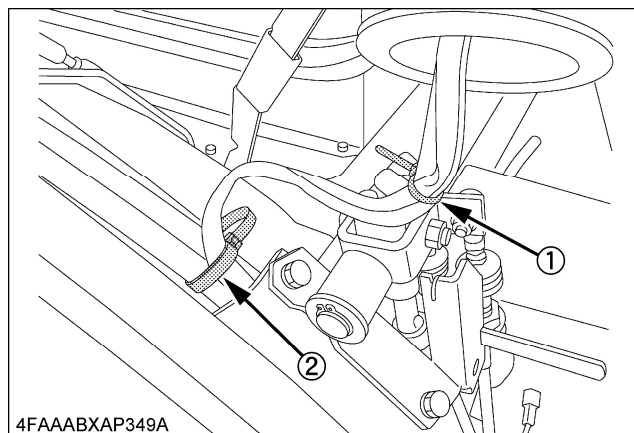

- (1) Band code (White)
- (2) Band code (Black)

◆ Wire harness for CAB model

1. Detach the steering wheel by removing the pad, M12 nut and spring washer. Then detach the meter panel by removing the three bolts.

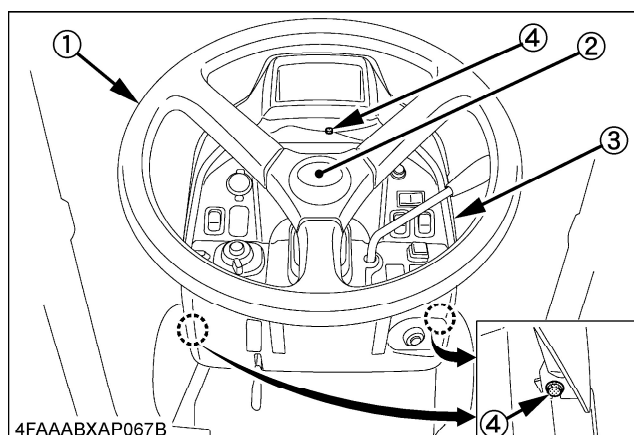

- (1) Steering wheel
- (2) Pad
M12 nut
Spring washer
- (3) Meter panel
- (4) Bolt

2. Disconnect the ignition switch wire harness, and remove the panel cover.

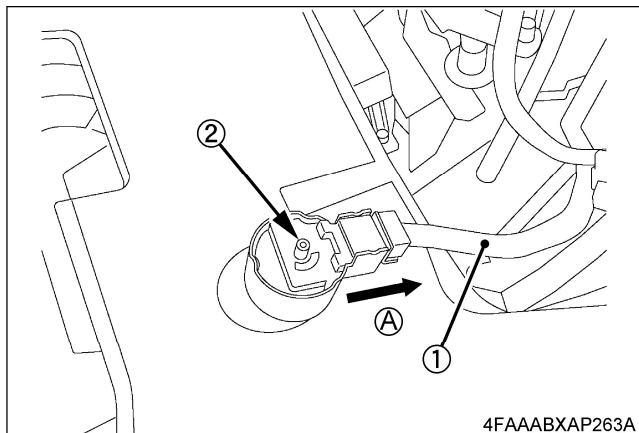

- (1) Harness
(2) Ignition switch
(A) Disconnect

3. Disconnect the relay from the connector as shown below. Reconnect the relay to the 3rd function wire harness.

[LX3310]

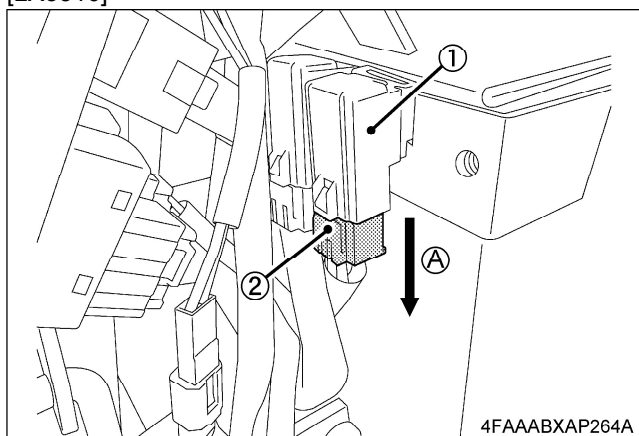

- (1) Relay
(2) Yellow connector
(A) Disconnect (Yellow connector)

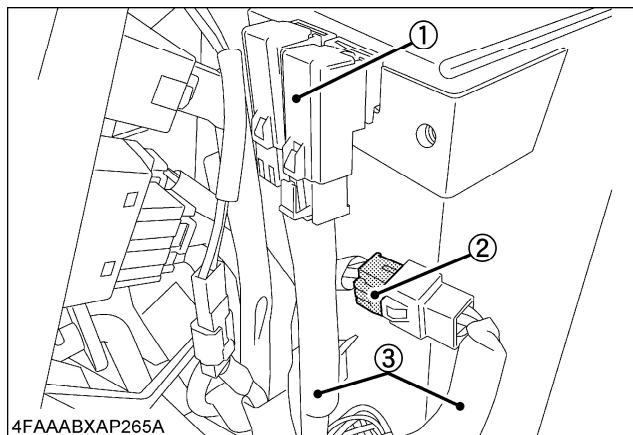

- (1) Relay
(2) Yellow connector
(3) 3rd function harness

[LX2610]

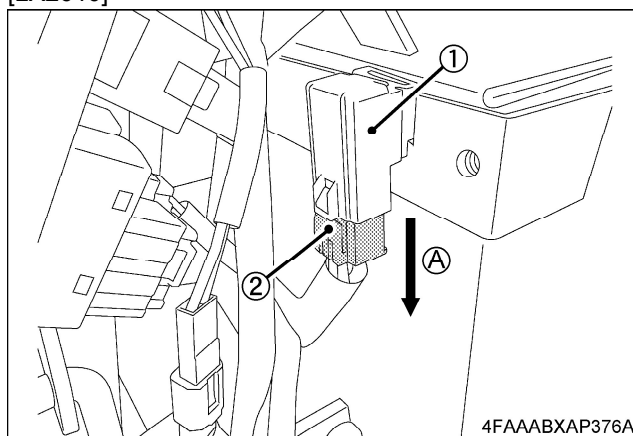

- (1) Relay
(2) White connector
(A) Disconnect (White connector)

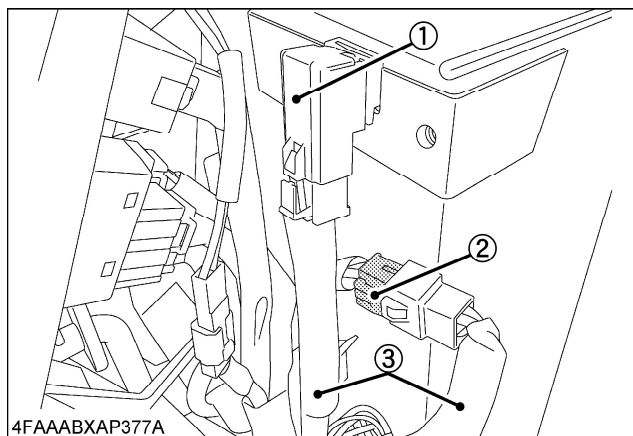

- (1) Relay
(2) White connector
(3) 3rd function harness

4. Apply the cushion on the panel frame as shown below.

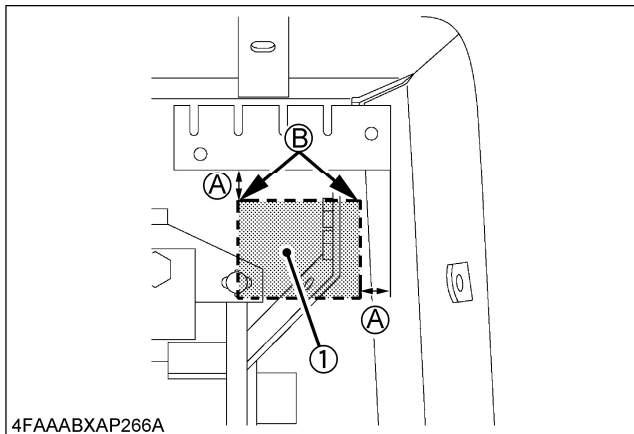

(1) Cushion

(A) 20 mm

(B) Longer side

5. Install the relay stay onto the meter panel stay.

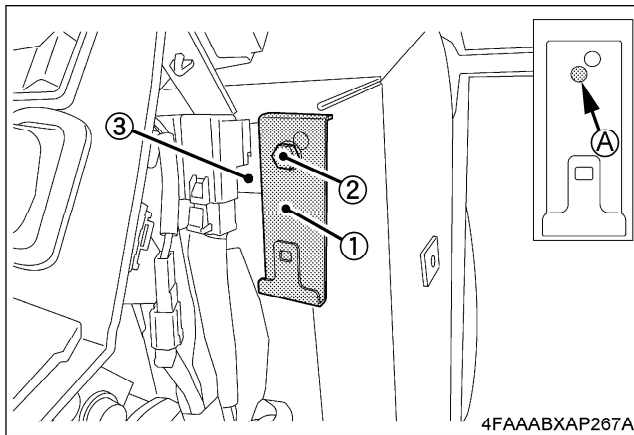

(1) Relay stay

(2) M6 bolt

(3) Meter panel stay

(A) Hole for CAB model

6. Insert the relays of the 3rd function wire harness into the relay stay and secure it.

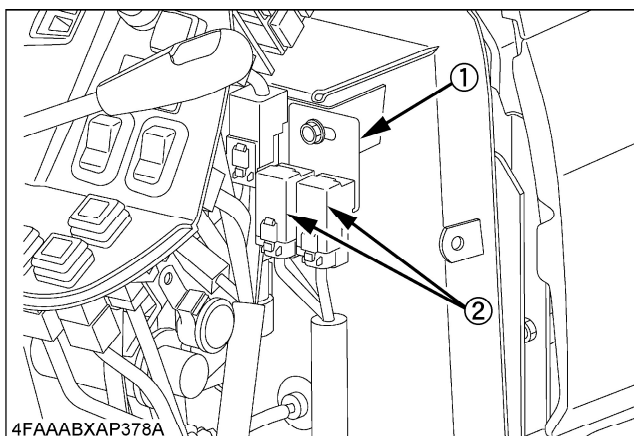

(1) Relay stay

(2) 2-Relays

7. To pass the wire harness, cut the floor mat as shown below.

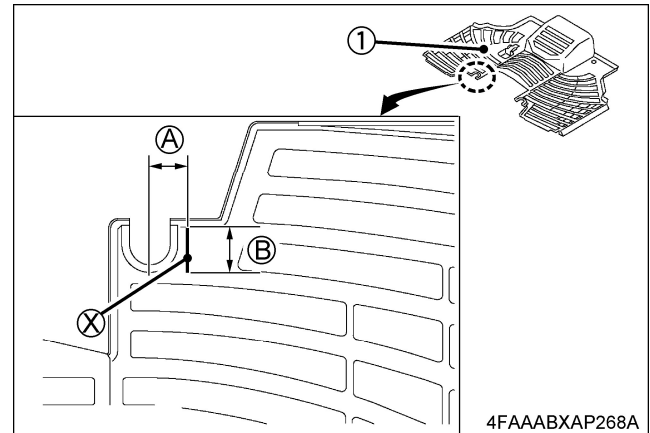

(1) Floor mat

(A) 38 mm (1.5 in)

(B) 38 mm (1.5 in)

(X) Cut line

8. Clamp the wire harness at the white-taped position as shown below.

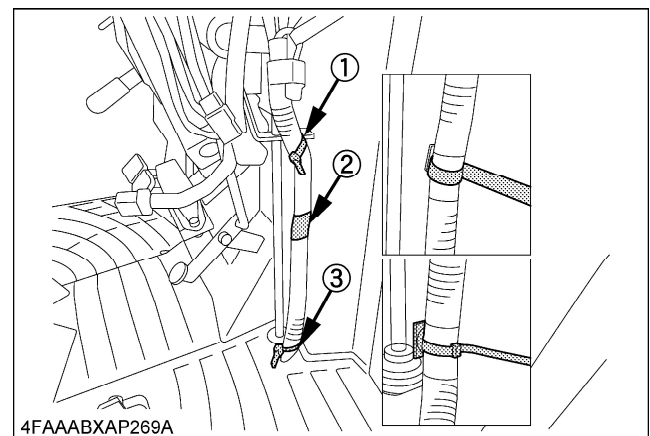

(1) Band code

(2) Stud type band (Natural)

(3) Tree type band (Black)

9. Remove the foot mat and cut the upper layer made of sponge of the floor mat as shown in the following figure.

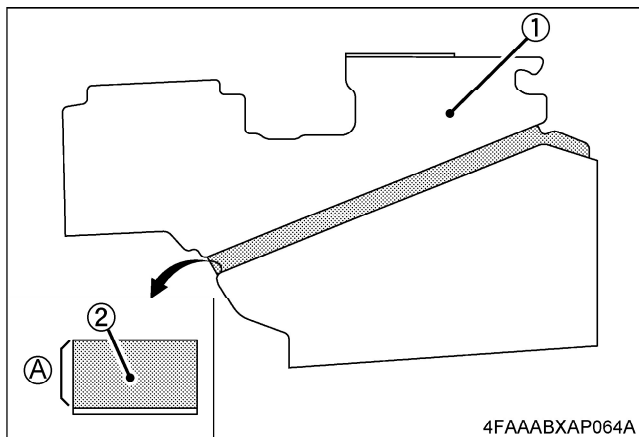

- (1) Foot mat
(2) Layer of sponge
(A) Cut

10. Pass the wire harness through the foot mat as shown in the following figure and connect the 3rd function control harness and the ON/OFF switch harness. And then pass the solenoid valve harness through the hole of the floor.

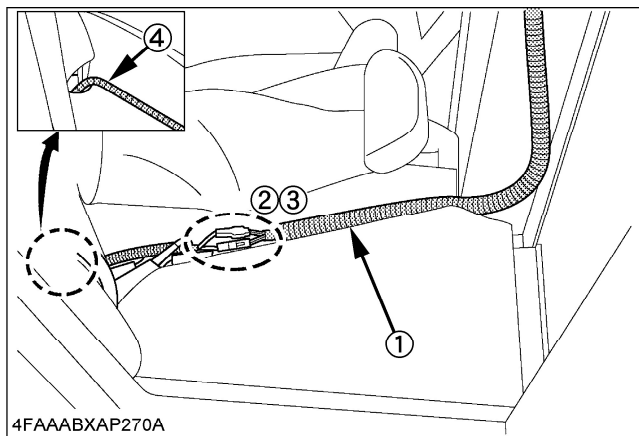

- (1) Wire harness
(2) 3rd function control harness
(3) ON/OFF switch harness
(4) Solenoid valve harness

11. Pass the wire harness as shown below. Clamp it at the white-taped positions.

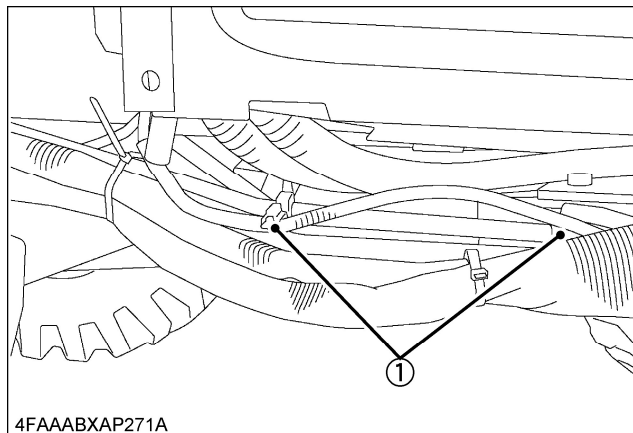

- (1) 2-W-clamp

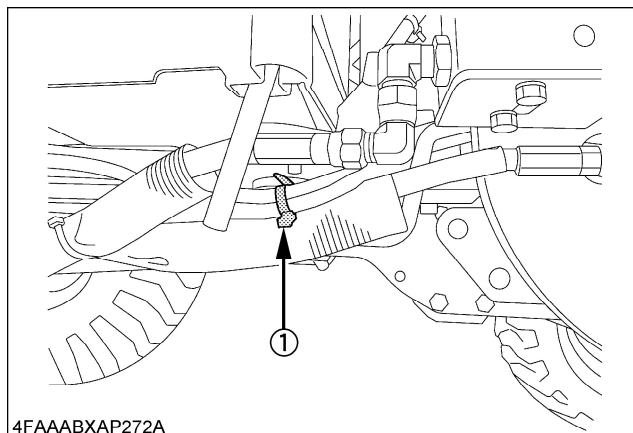

- (1) W-clamp

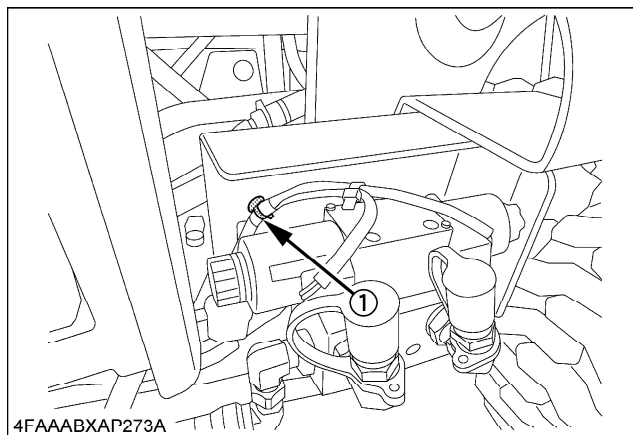

- (1) Tree type band

■ Tractor Side/ROPS Section

◆ Control Lever for ROPS model

1. Replace the original control lever with new one and pass the wire harness as shown below. Then, connect the wire harness.

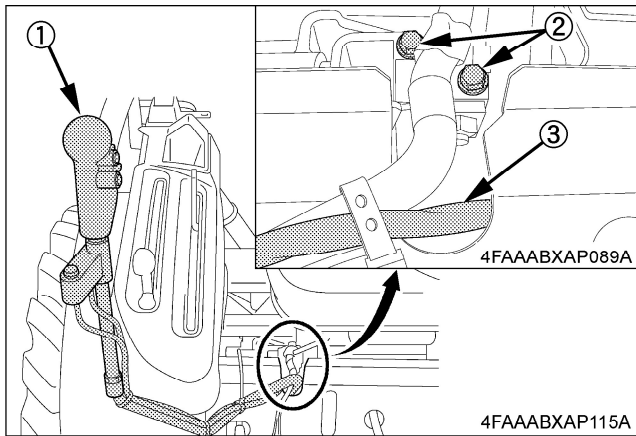

- (1) Control lever
- (2) 2-M6 bolts
- (3) Wire harness

◆ Wire harness for ROPS model

1. Detach the steering wheel removing the pad, an M12 nut and spring washer and then detach the meter panel removing the 5 bolts.

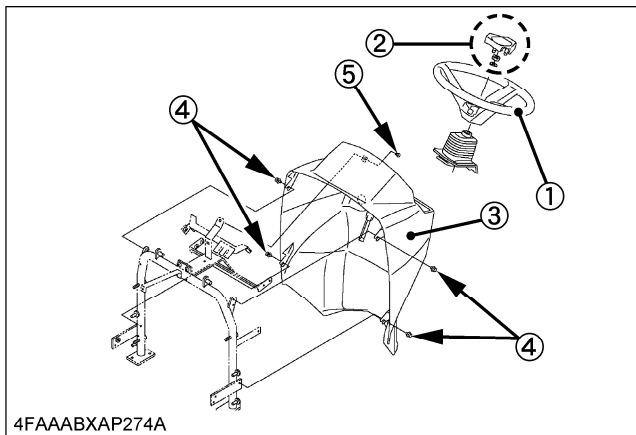

- (1) Steering wheel
- (2) Pad
M12 nut
Spring washer
- (3) Meter panel cover
- (4) 4-M16 x 14 bolt with washer
- (5) Screw

2. Install Relay stay on meter panel stay.

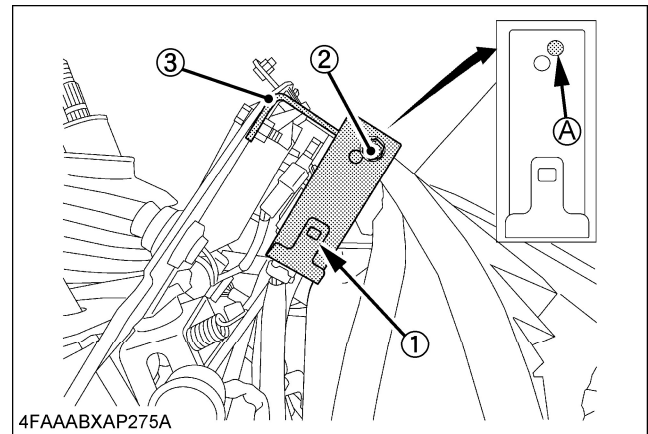

- (1) Relay stay
 - (2) M6 bolt
 - (3) Meter panel stay
- (A) Hole for ROPS model

3. Disconnect the relays and connect the wire harness as shown in the following figure.

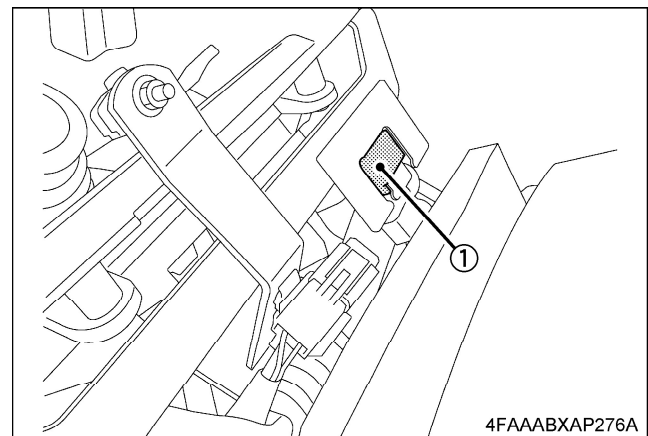

- (1) Relay

4. Connect the 3rd function harness as below. Then put connected relay on relay stay as shown in the figure.

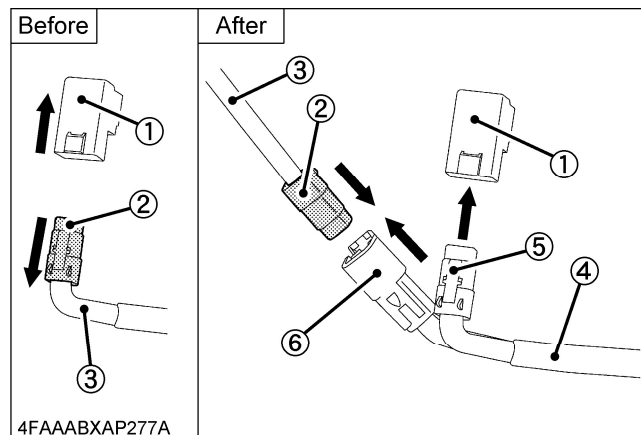

- (1) Relay (Tractor)
 (2) Power supply coupler (Yellow)
 (3) Tractor harness
 (4) 3rd function harness
 (5) Coupler (Male)
 (6) Coupler (Female)

5. Install two relays into the box on harness, then install it to relay stay.

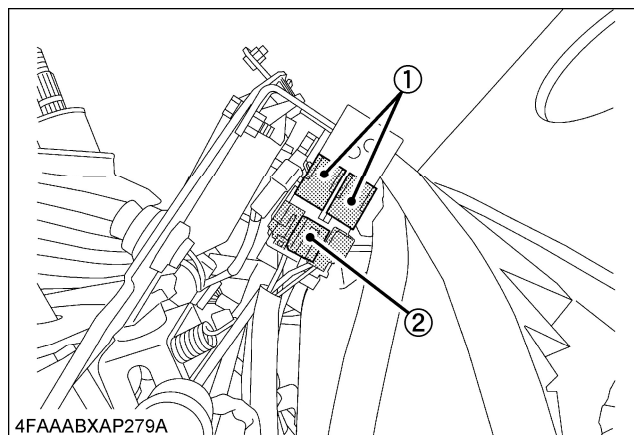

- (1) 2-Relay
 (2) Box on harness

6. Clamp the harness with band code as shown in the pictures.

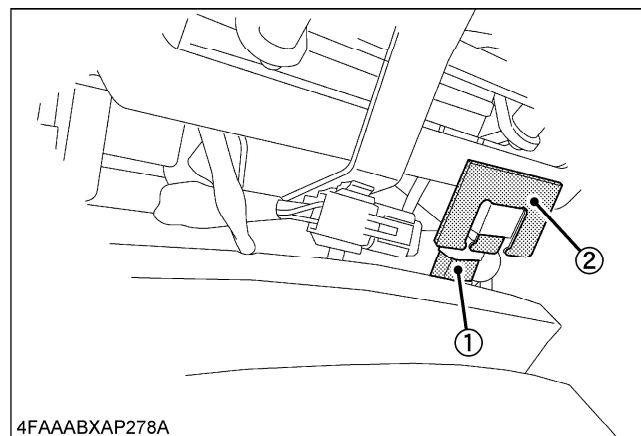

- (1) Connected relay
 (2) Relay stay

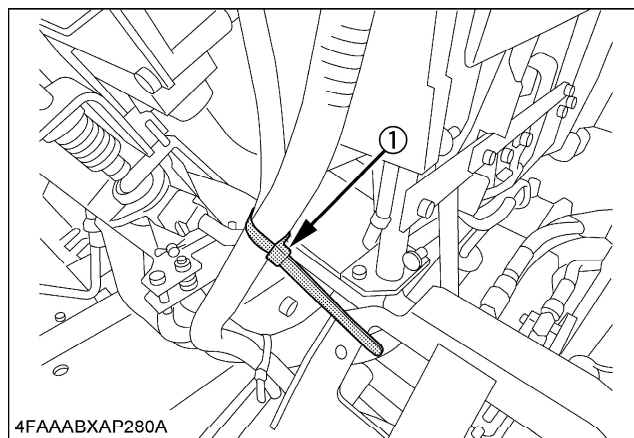

- (1) Band code

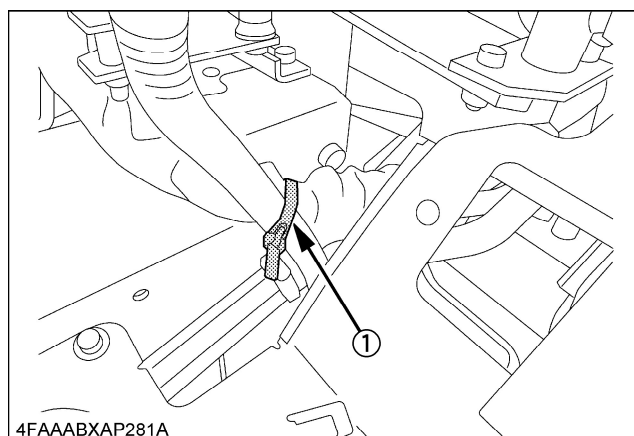

- (1) Band code